

Fixed, Adjustable & Electromechanical Louvres



Visit: www.helmengineering.co.za
Email: marketing@helmeng.co.za
Tel: 011 898 2900

Helm Louvres

 **helm**
MANUFACTURING INGENUITY

Helm Louvres

Adjustable louvers

Order Code	Height m (a)	Total free inlet area Per s.q meter		Number of Blades	Mass kg	
		1000 m width (b)	1500 m width (b)		1000 m width	1500 m width
HLA 3	0.530	0.318	0.512	3	18.3	29.0
HLA 4	0.695	0.458	0.734	4	21.6	33.4
HLA 5	0.800	0.598	0.956	5	25.0	38.3
HLA 6	1.035	0.738	1.178	6	28.4	43.1
HLA 7	1.190	0.578	1.400	7	31.7	47.7
HLA 8	1.355	1.018	1.622	8	35.1	52.0
HLA 9	1.520	1.158	1.844	9	38.6	57.6
HLA 10	1.685	1.298	2.066	10	41.9	62.4
HLA 11	1.850	1.438	2.288	11	45.3	67.3
HLA 12	2.015	1.578	2.510	12	48.4	72.1
HLA 13	2.180	1.718	2.732	13	52.0	77.0
HLA 14	2.345	1.858	2.954	14	55.4	81.8
HLA 15	2.510	1.998	3.176	15	58.9	66.7
HLA 16	2.675	2.138	3.398	16	62.1	91.6
HLA 17	2.840	2.278	3.620	17	65.6	95.4
HLA 18	3.005	2.418	3.842	18	69.0	100.0

Fixed louvres

Order Code	Height m (a)	Total free inlet area Per s.q meter		Number of Blades	Mass kg	
		1000 m width (b)	1500 m width (b)		1000 m width	1500 m width
HLF 4	0.595	0.278	0.429	4	14.4	21.2
HLF 5	0.735	0.416	0.638	5	16.6	24.4
HLF 6	0.875	0.544	0.843	6	18.8	27.6
HLF 7	1.015	0.692	1.050	7	21.0	30.9
HLF 8	1.155	0.830	1.257	8	23.2	34.1
HLF 9	1.295	0.968	1.464	9	25.4	37.3
HLF 10	1.435	1.106	1.671	10	27.6	40.5
HLF 11	1.575	1.244	1.878	11	29.8	43.7
HLF 12	1.715	1.382	2.085	12	32.0	46.9
HLF 13	1.855	1.520	2.292	13	34.2	50.1
HLF 14	1.995	1.658	2.499	14	36.4	53.3
HLF 15	2.135	1.795	2.706	15	38.6	56.5
HLF 16	2.275	1.934	2.913	16	40.8	59.7
HLF 17	2.415	2.072	3.120	17	43.0	62.9
HLF 18	2.555	2.210	3.327	18	45.2	66.1
HLF 19	2.695	2.348	3.534	19	47.4	69.3
HLF 20	2.835	2.486	3.741	20	49.6	72.6
HLF 21	2.975	2.624	3.948	21	51.8	75.8

Helm louvres are designed to operate in conjunction with either Helm powered or natural ventilators, to replace hot stale air at desired areas.

Fixed louvres provide permanent ventilation, where as adjustable louvres can be set to deliver a variable amount of air depending on the day to day climatic conditions. All louvre units are available in galvanised, aluminium, stainless steel and pre-painted material. Special sizes can be manufactured on request.

PLEASE NOTE: Due to our ongoing research and development programme, we reserve the right to supply products which may differ slightly from those illustrated and described in this brochure.

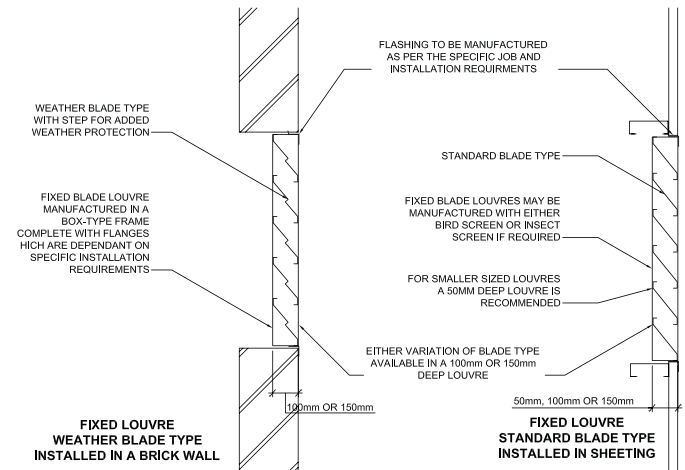
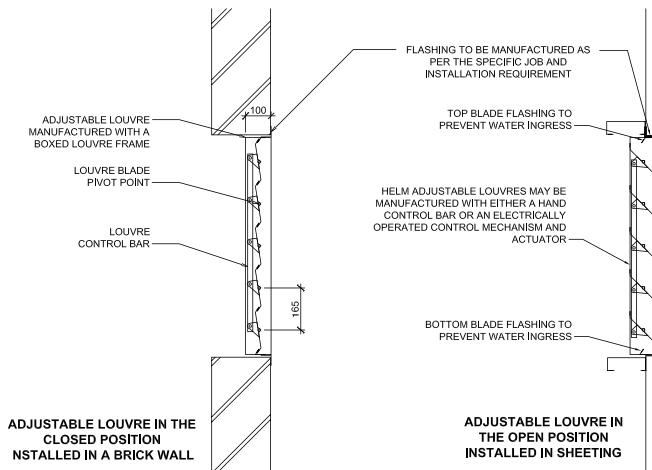

Helm AWL (Automated Wall Louvre) DR-AWL-001

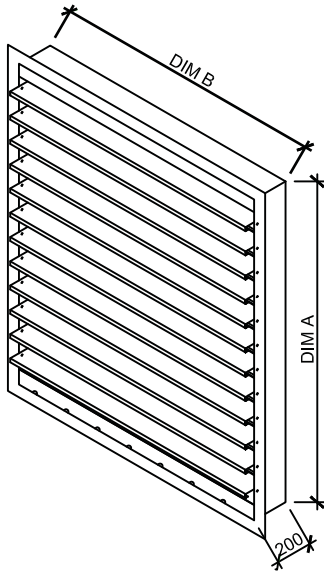

Standard Sizes

Blades	Dim. A
4	700
5	834
6	968
7	1102
8	1236
9	1370
10	1504
11	1638
12	1772
13	1906
14	2040
15	2174
16	2270

*Dim. B Maximum 2080mm

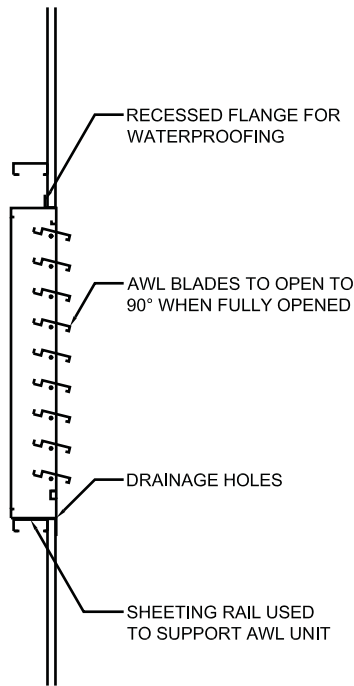

AWL Sheeting Installation

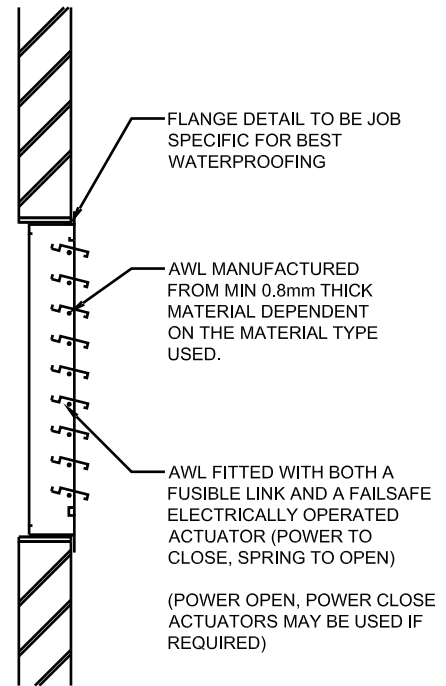

AWL Wall Installation

Features

Fusible link, Interlocking blades, Large Rain Channels, Ventilation coefficient ± 0.68

Optional extras

Burglar Bars/ Bird Proofing / Insect Proofing / Flanges & Flashings

Notes:

AWL available with the following material codes:
Galvanized, Aluminium, Zinalume and Chromadek
AWL can also be painted/ powder coated to specification.

Performance Tested

The H-AWL Louvre has been fully tested by an Independent Test Authority. Test results are available on request.
Tested to BSEN12101-2:2017 and EN compliant.

Function

Smoke Ventilation
Natural Ventilation

Specification Information

Helm AWL - Automated WALL LOUVRE complete with Fusible link (specified $^{\circ}C$) as backup and a failsafe, power close, spring to open or power close power to open, actuator 24V or 230V. Specify material to be used.

Areas most commonly used

Side Cladding / Brick Walls / Roof monitors

Sizes

Height: 175mm. Throat Width up to 2000mm. Length: 700 - 2174mm in increments of 134mm. Different bases to accommodate installation requirements.



Head Office, Isando, Kempton Park, Gauteng

Address: Corner Barlow & Quality Roads, Isando
General Enquires: Email: marketing@helmeng.co.za
Tel: +27 (0) 11 898 2900